

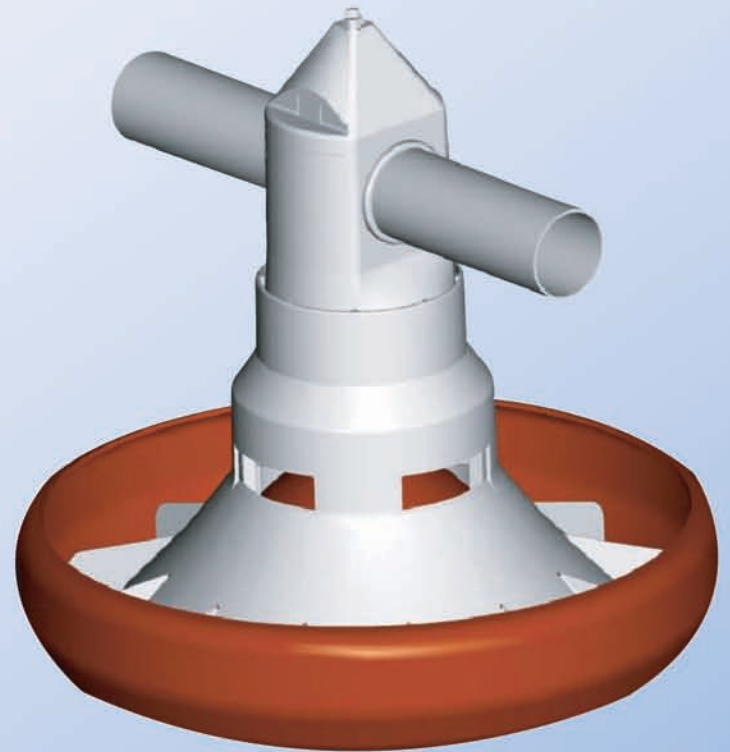

The new LAE-Tube Feeder for Broilers

- Free flow of feed at the start of feeding
- Rapid growth rate, especially in the first week
- Birds circulate easily around the system
- Optimum feed conversion
- Easy to clean
- Simple to install
- Highest quality



LAE - Anlagenbau GmbH

Altenwalder Chaussee 94 - 100 · 27472 Cuxhaven (Germany)

Phone: +49 4721 - 105-0 · Fax.: +49 4721 - 105 -210

E-mail: cux@lae-cuxhaven.de · Internet : <http://www.lae-cuxhaven.de>

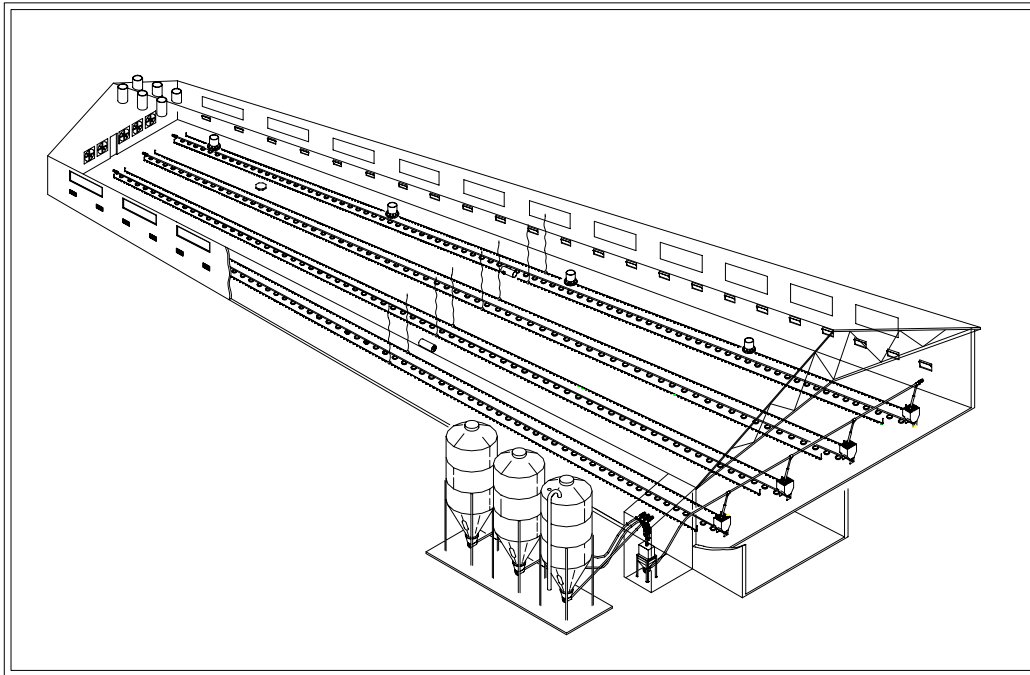

Technical data

lengths of system components (0.55 kW Drive)	up to max. 120 m	Drive	Gearmotor
Transport pipe	Ø 45 mm outside	Type of current	3-phase
Auger	Typ 45	Voltage	230/400 V; 50 cycles
Distances trough to trough	0.75 m	Performance	0.55 kW
	1.00 m	Power Input	1.5 Amps
	1.20 m	Torque	13.6 Nm
Contents of trough (pan)	approx. 1.6 kilos	Output drive turns	386 min-1
Trough diameter	330 mm	Contacteur	IP 54
		Transport capacity	max. 380 kilos/h
		Content of extension hopper	approx. 75 kg
		Kind of feed transported	meal, pellets

We reserve the right to make technical changes



LAE-Anlagenbau GmbH • Altenwalder Chaussee 94-100 • 27472 Cuxhaven (Germany)
 Phone: +49(0)4721-105-0 • Fax.: +49(0)4721-105-210
 Internet: <http://www.lae-cuxhaven.de> • e-mail: cux@lae-cuxhaven.de

Livestock Animal Equipment